



Remote control opening and closing, automatic reclosing



APP control, data query



Stable performance, safe and reliable



Metering, Protection, Early Warning

Application scenarios

Electricity Protection, Sustainable Electricity



Electrified railway station as power supply, transportation power distribution system, highway electromechanical system



Smart mining, factory electricity, base station



Environmental Monitoring Station, Remote Irrigation, Smart Greenhouse

Product Details

Brand	Matis	Leakage type	A/AC
Name	Smart Molded Case Circuit Breaker	Warranty	1 year
Model	MT88M	Leakage adjustable	30,100,300mA
Current	125A,250A,400A,630A	Pole(s)	3P+N

Dimensions

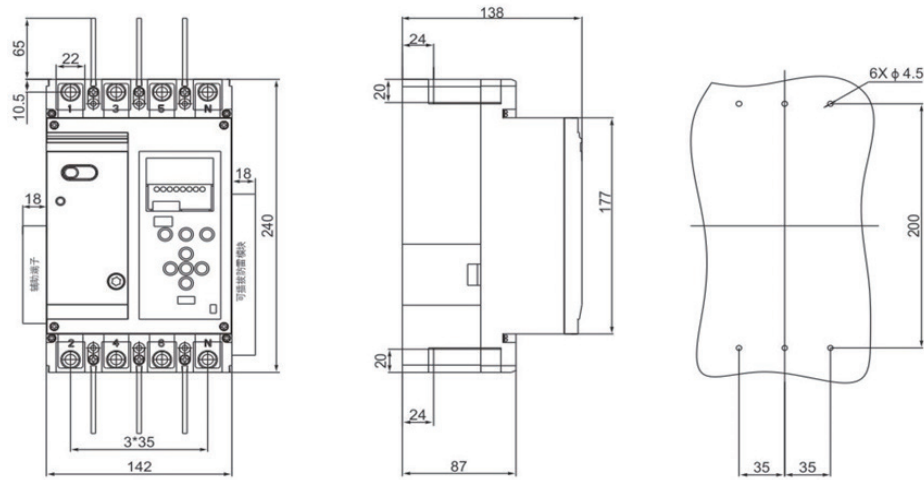

MX88M-250CY

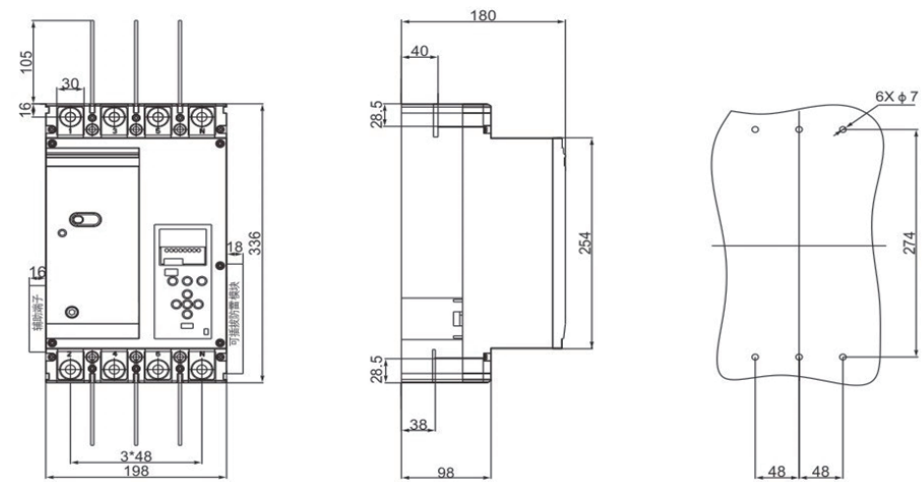

MX88M-400CY/MX88M-630CY

MT88M technical parameters

Product model		 250A	 400A	 630A
Electrical Characteristics				
Frame current (A)		250	400	630
Poles		3P+N		
Rated Voltage (V)		AC 400 50HZ		
Rated Insulation Voltage (V)		AC 1000		
Rated impulse withstand voltage Uimp (V)		8000		
Arc distance (mm)		≥50	≥100	≥100
Ultimate short-circuit breaking capacity Icu (KA)		50	72	70
Operating short-circuit breaking capacity Ics (KA)		35	50	50
Rated residual short-circuit making (breaking) capacity IΔm (KA)		12.5	20	20
Residual current operating characteristics		AC type		
Rated residual operating current IΔn (mA)		30/50/75/100/200/300/500/800/1000/Auto		
Residual action time characteristics		Delay type/Non-delay type		
Delay type limit non-driving time (s)		0.06/0.1/0.2 Optional: 2 IΔn See residual current protection characteristics for details		
Operational performance (times)	Power on	1000	1000	1000
	No power on	7000	4000	4000
	Total times	8000	5000	5000
Overload and short circuit characteristics		Three-stage protection, electronically adjustable, see "Protection Characteristics Description" for details		
Overvoltage protection value (V)		Setting value (265~350V)		
Undervoltage protection value (V)		Setting value (100~200V)		
Phase loss protection value (V)		Setting value (10~100V)		
Function description				
automatic reclosing		●	●	●
Leakage Protection		●	●	●
safety padlock		●	●	●
The leakage value is adjustable		●	●	●
Environment Characteristics				
Work Temperature		-25℃~-+55℃		
Storage Temperature		-40℃~-+70℃		
Relative humidity (non-condensing)		5%-95%		
highest altitude		2000 m		
Protection class		IP20		
Metering, control, automatic reclosing				
poles	communication method	Frame current range		model
4P	RS485	40~125A		MT88M-LM125
		100~250A		MT88M-LM250
		200~400A		MT88M-LM400
		315~630A		MT88M-LM630

www.matismart.com

mail:Info@matismart.com

Tel:+86 21 6050 3668,+86 18621879631

Add: Room 318-320, No.83,West Huanhu Road, Pudong, Shanghai, China 201306



Intelligent Molded Case Circuit Breaker iMCCB MT88M

Power on with intelligence, safer and more efficient



# MT88M Intelligent Molded Case Circuit Breaker

MT88M is an innovative power IoT high current metering molded case circuit breaker. It integrates a multifunction meter and a molded case circuit breaker. Realize protection, metering, monitoring, control and device management through APP and software platform.

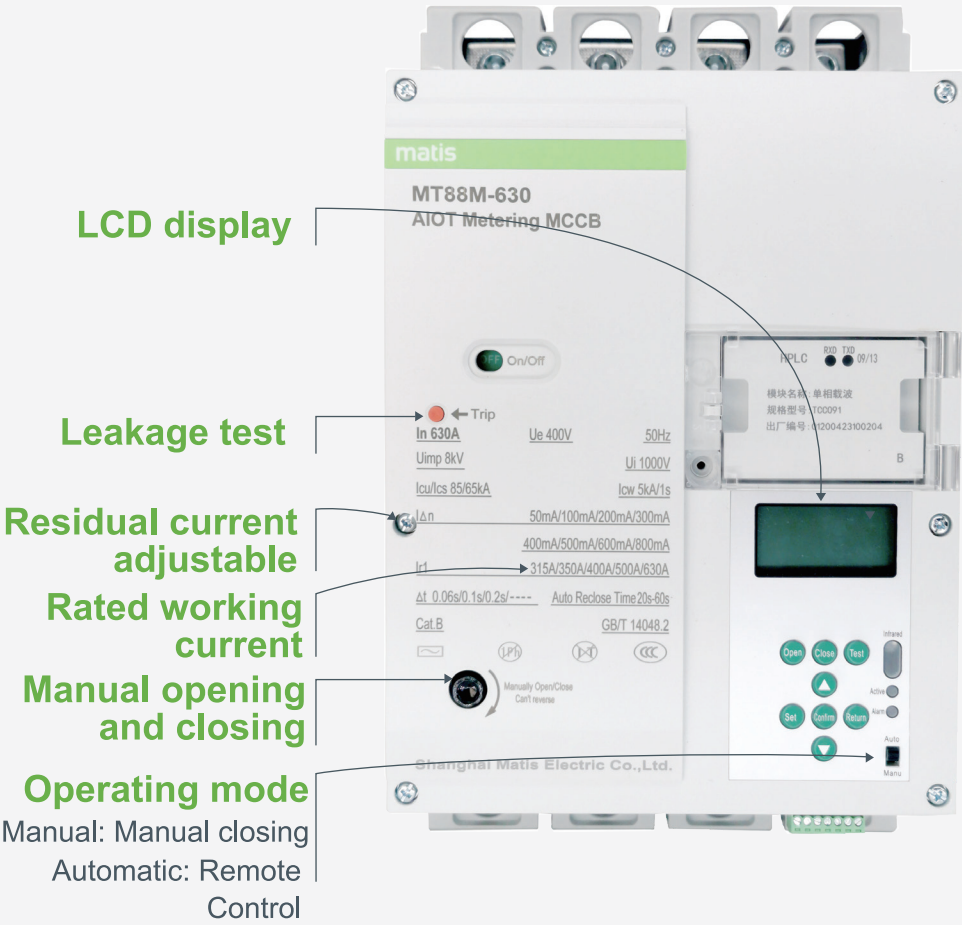

## With smart gateway MT88C

MT88C is an intelligent acquisition module, which transmits the collected data to Matis software platform or third-party platform through unlimited GPRS or Ethernet. The device has edge computing capabilities and storage capabilities.



MT88C



### Protective function

- > All-round protection and high breaking capacity ensure the reliability of line protection.
- > The residual current gear is adjustable, and the protection function and parameters can be set and modified online.



### Metering function

- > Residual current, three-phase power supply voltage, load current display
- > Real-time measurement of parameters such as active power and reactive power
- > Metering up to class 1.0



### multi-protocol control

- > Support DL/T645 protocol and Modbus protocol
- > Support online remote upgrade, easy to maintain and upgrade



### way of communication

- > RS485,HPLC
- > 4G, RJ45 gateway can be reconfigured to realize communication mode

## Integrate intelligent collection, analysis and management

### I/O control

MT88M is in the non-safety lock working mode, the device is connected to the power supply, the device is in the open state, and the dry contact can be used for remote control to control the opening and closing of the device.

### RS485 and Modbus control

MT88M is in the non-safety lock working mode, connect the device to the power supply, and the device is in the open state.



### Compatible host

Personal computer (PC),Inverter, PLC equipment, etc.

### Platform features

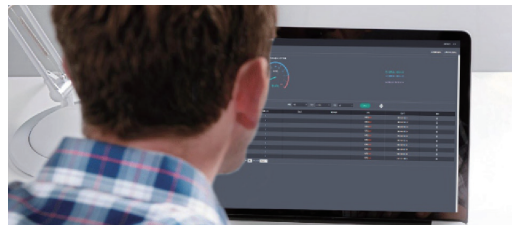

- Prepaid Management System
- Equipment Load Analysis
- Malfunction and accident warning
- Device management
- remote control
- Energy analysis

## MT88M and communication gateway wiring diagram

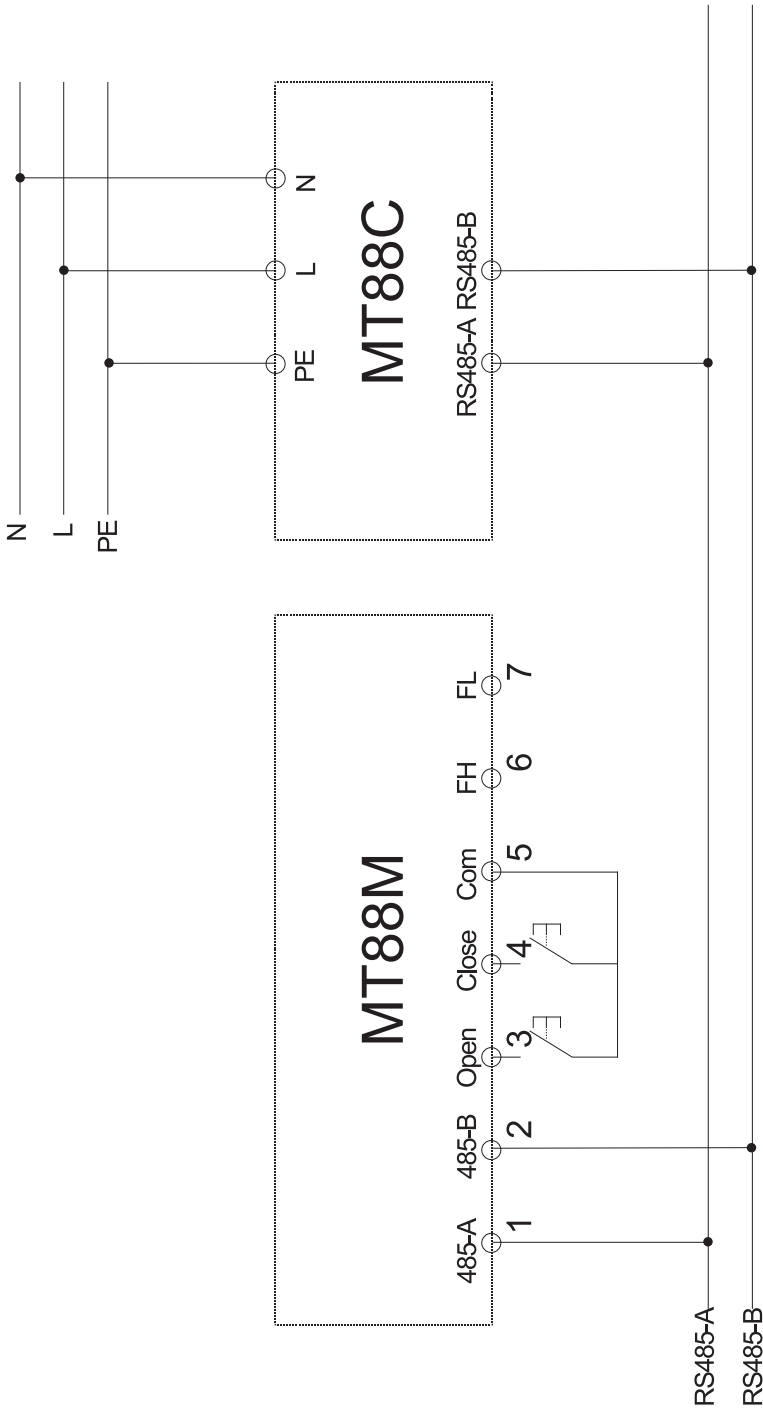

Note: COM port and OPEN, CLOSE port are passive interfaces.OPEN and CLOSE are a group of passive nodes that switch to each other.When CLOSE is closed, closing is performed; when OPEN is closed, opening is performed